

# Route Access Standard

## DIRN Section Pages D45 – Port Botany to Macarthur

### Applicability

ARTC Network Wide
SMS

### Publication Requirement

Internal & External
---------------------

### Primary Source

ARTC Stakeholders, Network Alteration Notices, SAFE Notices, Drivers Diagrams
---

### Document Status

Version #	Date Reviewed	Prepared by	Reviewed by	Endorsed	Approved
1.8	Apr 2018	Richard Potts	ARTC Stakeholders	Manager Standards	General Manager Technical Standards

### Amendment Record

<b>Amendments to the RAS are published at the following link</b>
<a href="https://www.artc.com.au/uploads/RAS_Amendments_Register.xlsx">https://www.artc.com.au/uploads/RAS_Amendments_Register.xlsx</a>

**Disclaimer**

This document has been prepared by ARTC for internal use and may not be relied on by any other party without ARTC's prior written consent. Use of this document shall be subject to the terms of the relevant contract with ARTC.

ARTC and its employees shall have no liability to unauthorised users of the information for any loss, damage, cost or expense incurred or arising by reason of an unauthorised user using or relying upon the information in this document, whether caused by error, negligence, omission or misrepresentation in this document.

**This document is uncontrolled when printed.**

Authorised users of this document should visit ARTC's intranet or extranet ([www.artc.com.au](http://www.artc.com.au)) to access the latest version of this document.

# 1 D45–Sydney Freight Network (SFN) Port Botany to Macarthur

(\*includes Chullora South Junction to Flemington South)

NB: These line maps are indicative only and should be reviewed in conjunction with the legend on Page3. For more detailed map information refer to the ARTC website.

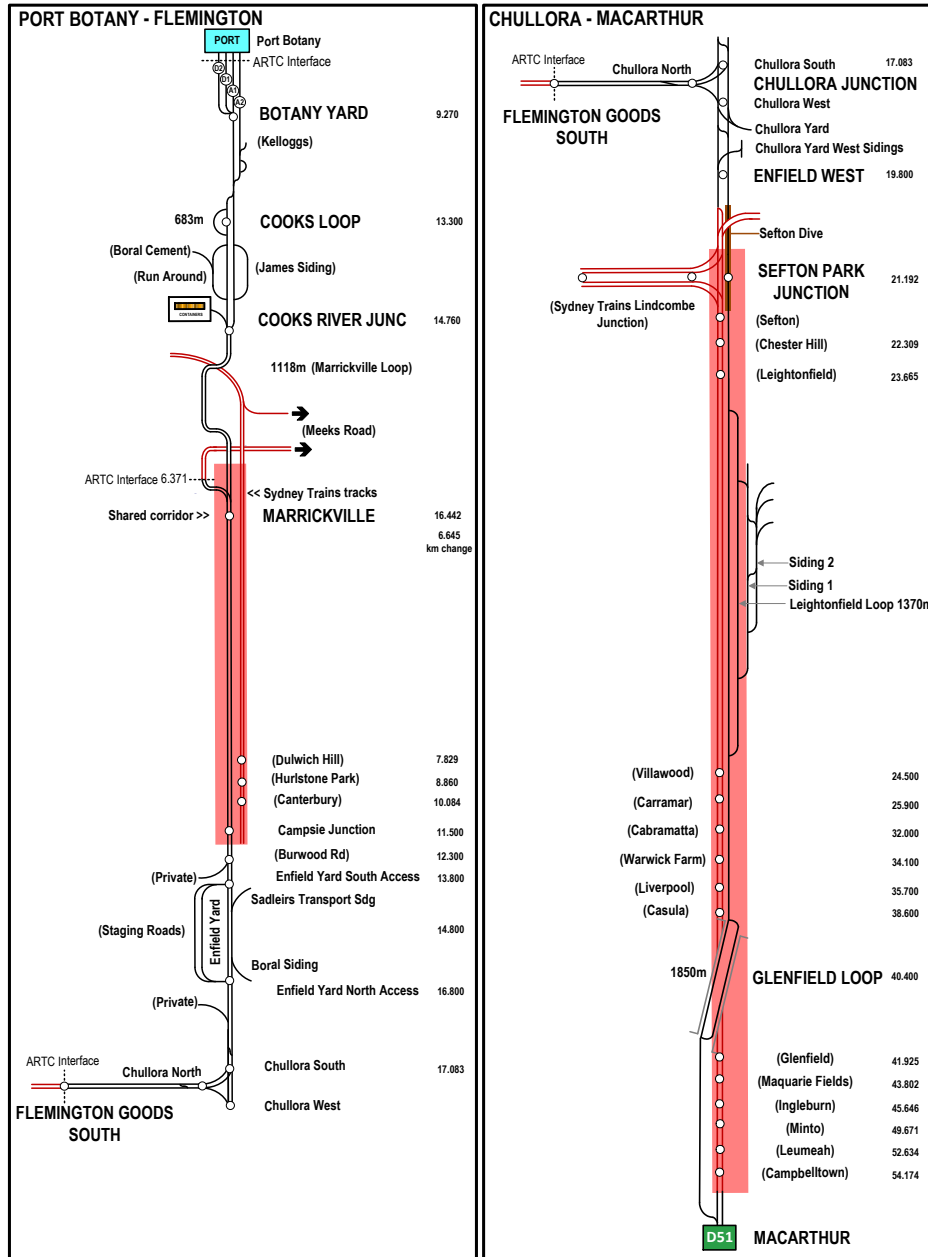

2 D45 Legend

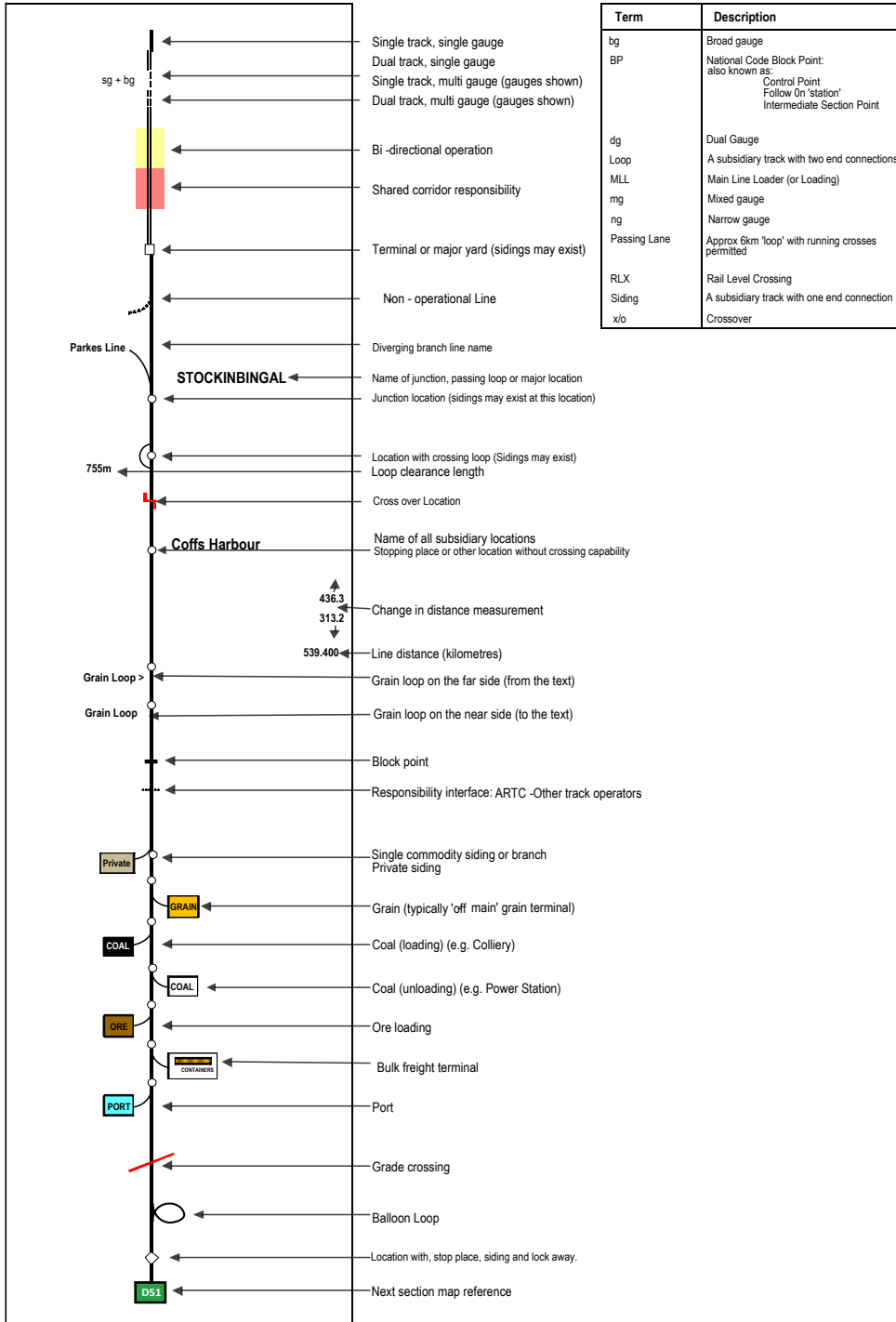

### 3 D45 Route Capacity

PORT BOTANY – COOKS RIVER			
TRAIN TYPE	MAXIMUM SPEED	MAXIMUM AXLE LOAD (TONNES)	
	(KM/H)	LOCOS	WAGONS
FREIGHT	50	22.8	23
	40	22.8	25
<b>PASSENGER</b>			
XPT/RAILCAR	50		
DIESEL HAUL	20		

*Note: Route capacity applies where vehicle characteristics and conditions permit.*

COOKS RIVER – MARRICKVILLE			
TRAIN TYPE	MAXIMUM SPEED	MAXIMUM AXLE LOAD (TONNES)	
	(KM/H)	LOCOS	WAGONS
FREIGHT	50	22.8	23
	40	22.8	25
<b>PASSENGER</b>			
XPT/RAILCAR	50		
DIESEL HAUL	20		

*Note: Route capacity applies where vehicle characteristics and conditions permit.*

MARRICKVILLE – FLEMINGTON SOUTH			
TRAIN TYPE	MAXIMUM SPEED	MAXIMUM AXLE LOAD (TONNES)	
	(KM/H)	LOCOS	WAGONS
FREIGHT	70	22.8	25.0
<b>PASSENGER</b>			
XPT	70		

*Note: Route capacity applies where vehicle characteristics and conditions permit.*

<b>CHULLORA NORTH JUNCTION - CHULLORA WEST JUNCTION (NORTH FORK TRIANGLE)</b>				
<b>TRAIN TYPE</b>	<b>MAXIMUM SPEED</b>		<b>MAXIMUM AXLE LOAD (TONNES)</b>	
	<b>(KM/H)</b>	<b>LOCOS</b>	<b>WAGONS</b>	
FREIGHT	70	22.8	25.0	
<b>PASSENGER</b>				
XPT	70			

*Note: Route capacity applies where vehicle characteristics and conditions permit.*

<b>CHULLORA SOUTH JUNCTION– SEFTON PARK SOUTH JUNCTION (KM CHANGE)</b>				
<b>TRAIN TYPE</b>	<b>MAXIMUM SPEED</b>		<b>MAXIMUM AXLE LOAD (TONNES)</b>	
	<b>(KM/H)</b>	<b>LOCOS</b>	<b>WAGONS</b>	
FREIGHT	70	22.8	25.0	
<b>PASSENGER</b>				
XPT	70			

*Note: Route capacity applies where vehicle characteristics and conditions permit.*

<b>SEFTON PARK SOUTH JUNCTION (KM CHANGE) – MACARTHUR</b>				
<b>TRAIN TYPE</b>	<b>MAXIMUM SPEED</b>		<b>MAXIMUM AXLE LOAD (TONNES)</b>	
	<b>(KM/H)</b>	<b>LOCOS</b>	<b>WAGONS</b>	
FREIGHT	115	22.3	21	
	100	22.8	23	
	80	22.8	25	
<b>PASSENGER</b>				
XPT/ RAILCAR	115	N/A		
DIESEL HAUL	115	19		

*Note: Route capacity applies where vehicle characteristics and conditions permit.*

## 4 D45 Special Access Conditions

### 4.1 Maximum Length of Trains

AREA	MAXIMUM TRAIN LENGTH (M)
PORT BOTANY TO MACARTHUR	1800 MAX/AS PER ALLOCATED TRAIN PATH.

## 5 D45 Location of Speed Signs

PORT BOTANY – MARRICKVILLE					
LOCATION	KILOMETRAGE	DOWN TRACK		UP TRACK	
		NORMAL	XPT	NORMAL	XPT
173B POINTS	6.658	X30	-	-	-
173A POINTS	6.709	-	-	X30	-
172 POINTS	6.749	-	-	X30	-
171B POINTS	6.758	X30	-	-	-
170B POINTS	6.792	X30	-	-	-
171A POINTS	6.800	-	-	X30	-
170A POINTS	6.866	-	-	X30	-
169 POINTS	7.163	-	-	X30	-
168 POINTS	7.174	-	-	X30	-
166B POINTS	7.195	X15	-	-	-
165B POINTS	7.233	X30	-	-	-
165A POINTS	7.294	-	-	X30	-
164A POINTS	7.410	-	-	X15	-
163 POINTS	7.471	-	-	X30	-
162A-B POINTS	7.858	X15	-	-	-
162A POINTS	7.907	-	-	X15	-
160B POINTS	8.138	X30	-	-	-
160A POINTS	8.204	-	-	X30	-
159B POINTS	8.275	X30	-	-	-
158B POINTS	8.332	X30	-	-	-
159A POINTS	8.353	-	-	X30	-
157A POINTS	8.401	-	-	X30	-
156A POINTS	8.499	-	-	X30	-
	9.941	Start Single Line – Bi directional working			
	10.100	30	-	-	-
BOTANY	10.410	-	-	-	-
	11.583	10 (LX)	-	-	-
	11.883	-	-	10 (LX)	-

PORT BOTANY – MARRICKVILLE					
LOCATION	KILOMETRAGE	DOWN TRACK		UP TRACK	
		NORMAL	XPT	NORMAL	XPT
	12.649	End Single Line (790A)			
(Boral Cement Sidings)	14.140km			End of Signalled Authority	
	14.585	-	-	30	-
	14.737			X35	X35
COOKS RIVER					
	14.760	-	-		-
	14.830		-	-	-
	14.698 (Run Around)	X10	X10		
	14.855	50 (X35 782A)	-	35 (783A)	
	14.912	-	-	(50 DN direction)X35 (782B)	-
	16.127	35	-	-	-
	16.289	50	-	-	-
	16.375	-	-	50	
MARRICKVILLE – CHULLORA WEST JUNCTION					
LOCATION	KILOMETRAGE	DOWN TRACK		UP TRACK	
		NORMAL	XPT	NORMAL	XPT
MARRICKVILLE JUNC	6.645 (KM CHANGE FROM 16.422)	-	-	-	-
	6.670	-	-	X35	-
	6.710	-	-	35	-
	7.000	40	-	-	-
	8.570	-	-	40	
	8.870	50	-	-	-



	9.980	-	-	50	-
	10.280	60	-	-	-
CAMPsie	11.697	-	-	-	-
	11.860	50	-	60	-
	12.600	-	-	50	-
	12.900	60	-	-	-
	13.584	-	-	60	-
(down goods)	13.645	X40 (301A to through road 2)	-	-	-
(up goods)	13.720	-	-	X40 (301B from through road 2)	-
*(up goods) ENFIELD SOUTH YARD (see Enfield South Yard to Enfield North Yard)	13.730	-	-	X45 (302A DN Direction)	-
ENFIELD SOUTH YARD	13.735	-	-	X25	-
	13.780	-	-	-	-
	14.080	55	-	-	-
	15.000	-	-	55	-
ENFIELD	15.383	60	-	-	-
	16.607	-	-	60	-
ENFIELD NORTH YARD	16.800	70	-	-	-
*(see Enfield South Yard to Enfield North Yard)	16.830	-	-	X45 (340B to staging roads)  40 DN Direction 341B)	-
	16.920	(X40 UP Direction)	-	-	-
CHULLORA SOUTH JUNC	16.932	-	-	-	-

*to chullora west junc	17.008	-	-	X25 (DN direction)	-
for chullora yard	17.299	-	-	X25 (DN direction)	-
CHULLORA WEST JUNC	17.390	-	-	-	-

**CHULLORA WEST JUNCTION - MACARTHUR**

LOCATION	KILOMETRAGE	DOWN TRACK		UP TRACK	
		NORMAL	XPT	NORMAL	XPT
ENFIELD WEST	19.800	-	-	-	-
	20.095	X60	-	-	-
	20.500	70	-	X60	-
Single Line Bi-Directional Working with increasing chainage					
SEFTON PARK EAST JUNCTION	20.657	-	-	-	-
	21.050	-	-	-	-
SEFTON PARK SOUTH JUNCTION	22.309	-	-	-	-
	22.351	70	-	70	-
KM CHANGE AT	22.434/20.800	-	-	-	-
SEFTON	21.192	-	-	-	-
CHESTER HILL	22.309	-	-	-	-
	22.560	X25	-	80	-
SSFL LEIGHTONFIELD LOOP	22.629	25	-	-	-
SSFL LEIGHTONFIELD LOOP	24.225	-	-	25	-
SSFL GLENFIELD LOOP	24.300	80	-	X25	-
	39.400	X60	-	-	-
	39.415	-	-	80	-
	39.470	60	-	-	-
SSFL GLENFIELD LOOP	40.038	65	-	80	-
	40.180	80	-	65	-
	41.400	-	-	60	-
	41.480	80	-	X60	-

	41.610	115	-	80	-
	49.490	105	-	115	-
UP SOUTH MAIN	53.850	100	-	105	-
MACARTHUR	57.206				
	57.835	X90	-	100	-
	58.090	100	-	X90	-
UP SOUTH MAIN	58.100	X90	-	-	-
DOWN SOUTH MAIN	58.225	95	-	X90	-

**\* FLEMINGTON SOUTH JUNCTION - CHULLORA SOUTH JUNCTION**

LOCATION	KILOMETRAGE	DOWN TRACK		UP TRACK	
		NORMAL	XPT	NORMAL	XPT
FLEMINGTON SOUTH JUNC	18.909	-	-	-	-
CHULLORA NORTH JUNC towards Enfield West	17.597	-	-	-	-
CHULLORA WEST JUNC towards Campsie	17.309	-	-	X25	-
	17.207	-	-	70 (DN Direction)	-
CHULLORA SOUTH JUNC	16.932	X25	-	-	-

**\* ENFIELD SOUTH YARD – ENFIELD NORTH YARD**

LOCATION	KILOMETRAGE	DOWN TRACK		UP TRACK	
		NORMAL	XPT	NORMAL	XPT
*ENFIELD SOUTH YARD (up goods)	13.730	-		X45 (302A DN Direction)	-
(through road No 2)	13.800	45		X45 (302B)	
(through road No 2)	14.040	X15 (intermodal)			
(through road No 2)	14.151	X15	-	-	-

				X45 (306A to staging road 1)		
(staging road No 1)	14.295	45			X45 (through to road 2)	
(staging road 1)	14.620	X45 (380 to staging road 2)	-	-	-	
(staging road 2)	14.695	45	-		X45 (380 to staging road)	-
(staging road 2)	15.451	X45 (383A to staging road 1)				
(staging road 1)	15.535	X45 (383B to staging road 2)				
(staging road 1)	15.551				X45 (384A to staging road 2)	
(staging road 2)	15.633				X45 (384B to staging road 1)	
(staging road 2)	16.410	X45 (387 to staging road 1)	-	45	-	
(staging road 1)	16.450				X45 (387 to staging road 2)	
(staging road)	16.660			45		
(staging road)	16.665	X45 (340A)	-	-	-	
ENFIELD NORTH YARD (main line)	16.800	70			-	
*ENFIELD NORTH YARD (main line)	16.830	-	-		X45 (340B to staging roads)	-
					X40 DN Direction 341)	