

# I4 Gap - Narwonah

## RAS IN Section Page

**Applicability**

---

ARTC Network Wide

---

SMS

---

**Publication Requirement**

---

Internal / External

---

**Primary Source**

---



---

**Document Status**

Version #	Date Reviewed	Prepared by	Reviewed by	Endorsed	Approved
2.1	10 Feb 22	Operations Standards	Stakeholders	Operations Standards Manager	A/GM Technical Standards 11/02/2022

**Amendment Record**

---

**Amendments to the RAS are published at the following link**

---

<https://www.artc.com.au/uploads/RAS-Amendment-Register-Master.xlsx>

---

All changes in this document are highlighted with this colour

---

**Disclaimer**

This document has been prepared by ARTC for internal use and may not be relied on by any other party without ARTC's prior written consent. Use of this document shall be subject to the terms of the relevant contract with ARTC.

ARTC and its employees shall have no liability to unauthorised users of the information for any loss, damage, cost or expense incurred or arising by reason of an unauthorised user using or relying upon the information in this document, whether caused by error, negligence, omission or misrepresentation in this document.

**This document is uncontrolled when printed.**

Authorised users of this document should visit ARTC's intranet or extranet ([www.artc.com.au](http://www.artc.com.au)) to access the latest version of this document.

## Table of Contents

Table of Contents .....	2
1 Network Diagram .....	3
2 Route Capacity .....	6
3 Permanent Speed Restrictions .....	8

1 Network Diagram

I4

NARWONAH – DUBBO – MERRYGOEN – GAP – WERRIS CREEK

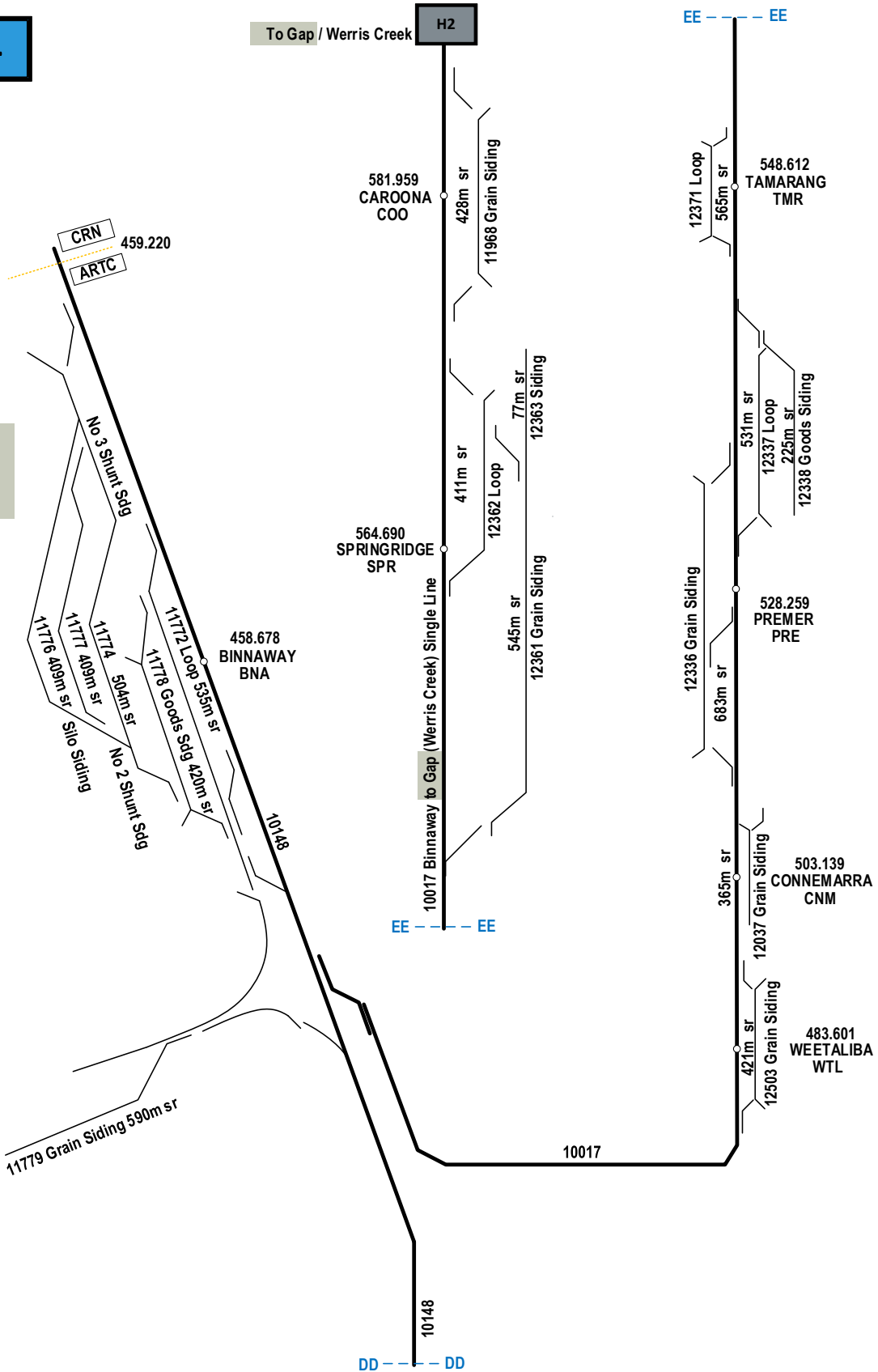

**14**

**NARWONAH – DUBBO – MERRYGOEN – GAP – WERRIS CREEK**

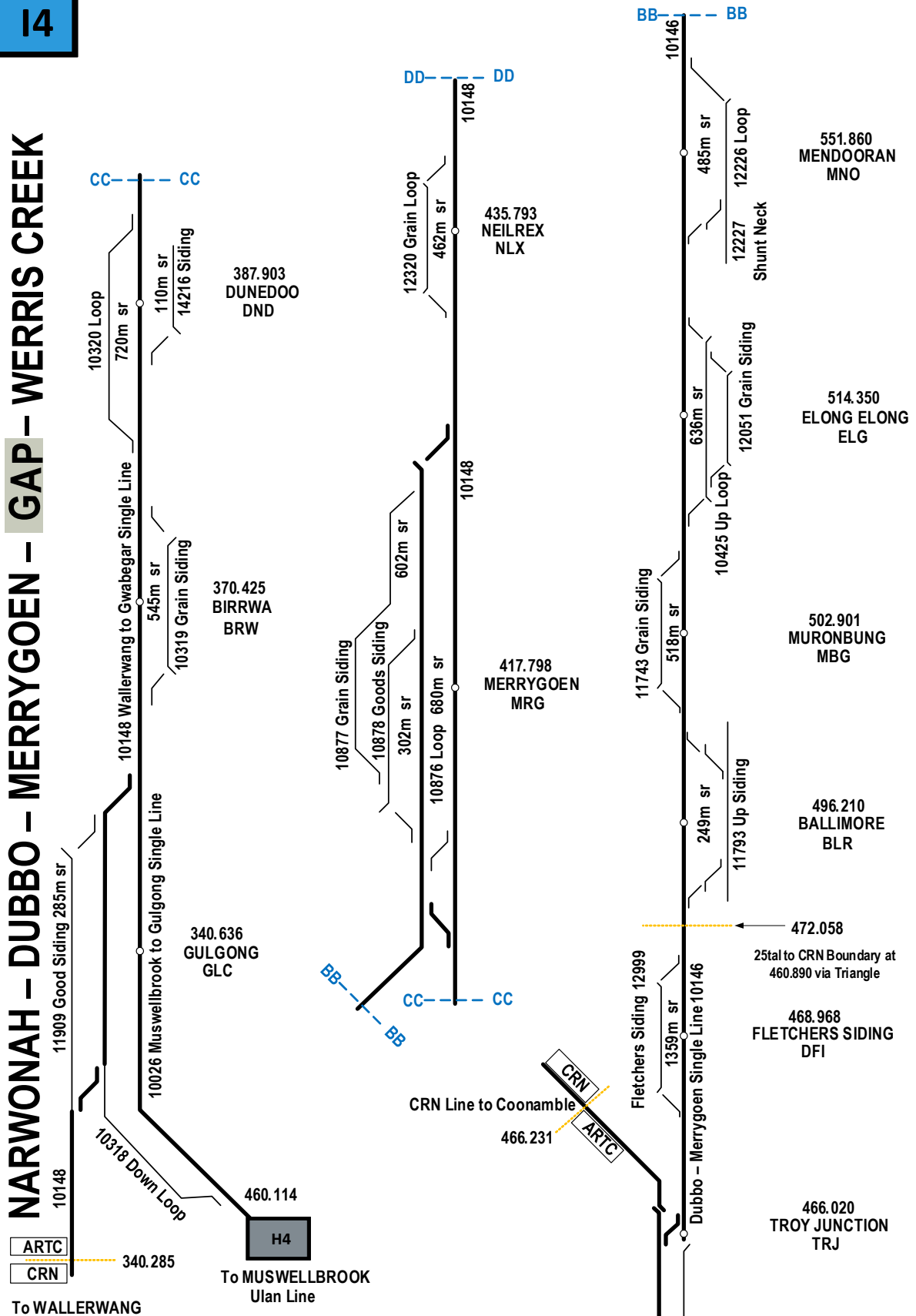

**14**

**NARWONAH – DUBBO – MERRYGOEN – GAP – WERRIS CREEK**

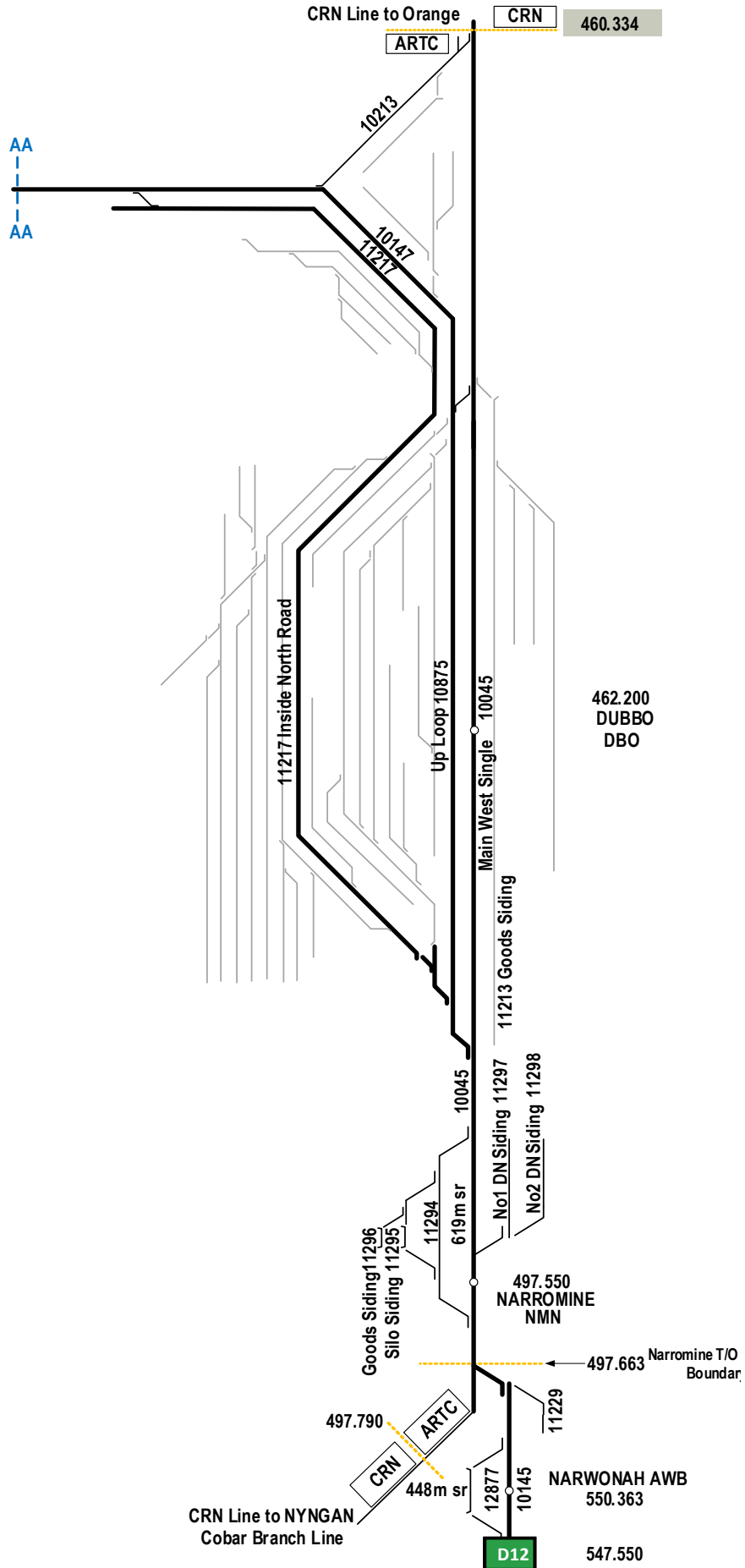

## 2 Route Capacity

<b>GAP – MERRYGOEN</b>			
<b>TRAIN TYPE</b>	<b>MAXIMUM SPEED</b>	<b>MAXIMUM AXLE LOAD (TONNES)</b>	
<b>FREIGHT</b>	<b>(KM/H)</b>	<b>LOCOS</b>	<b>WAGONS</b>
	100	19	19.5
	80	22.3	19.5
	70	22.3	20.25
	60	22.8	20.25
<b>PASSENGER</b>	<b>(KM/H)</b>	<b>LOCOS</b>	<b>CARRIAGES</b>
EXPRESS PASSENGER TRAIN	100	N/A	N/A
XPLORER	100	N/A	N/A
DIESEL HAUL	100	N/A	19
<b>MERRYGOEN – NARWONAH 547.550km</b>			
<b>TRAIN TYPE</b>	<b>MAXIMUM SPEED</b>	<b>MAXIMUM AXLE LOAD (TONNES)</b>	
<b>FREIGHT</b>	<b>(KM/H)</b>	<b>LOCOS</b>	<b>WAGONS</b>
	100	19	19.5
	80	22.3	19.5
	70	22.3	20.25
	60	22.8	20.25
<b>PASSENGER</b>	<b>(KM/H)</b>	<b>LOCOS</b>	<b>CARRIAGES</b>
EXPRESS PASSENGER TRAIN	100	N/A	N/A
XPLORER	100	N/A	N/A
DIESEL HAUL	100	19	19

*Note: Route capacity applies where vehicle characteristics and conditions permit.*

<b>NARROMINE 497.633 – CRN Boundary 497.790 (Cobar Branch Line)</b>			
<b>TRAIN TYPE</b>	<b>MAXIMUM SPEED</b>	<b>MAXIMUM AXLE LOAD (TONNES)</b>	
<b>FREIGHT</b>	<b>(KM/H)</b>	<b>LOCOS</b>	<b>WAGONS</b>
	100	19	19
	80	22.3	19.5
	70	22.3	20.25
	60	22.8	20.25
<b>PASSENGER</b>	<b>(KM/H)</b>	<b>LOCOS</b>	<b>CARRIAGES</b>
EXPRESS PASSENGER TRAIN	100	N/A	N/A
XPLOERER	100	N/A	N/A
DIESEL HAUL	100	19	19

*Note: Route capacity applies where vehicle characteristics and conditions permit.*

<b>FLETCHERS SIDING 472.058 – CRN Boundary 460.334 (Via Triangle Loop)</b>			
<b>TRAIN TYPE</b>	<b>MAXIMUM SPEED</b>	<b>MAXIMUM AXLE LOAD (TONNES)</b>	
<b>FREIGHT</b>	<b>(KM/H)</b>	<b>LOCOS</b>	<b>WAGONS</b>
	20	22.8	25.0

### 3 Permanent Speed Restrictions

DUBBO – GAP					
LOCATION	KILOMETRAGE	DOWN		UP	
		NORMAL	EXPRESS PASSENGER TRAIN	NORMAL	EXPRESS PASSENGER TRAIN
CRN LINE ORANGE	322.624				
END KM FOR CRN	460.334				
DUBBO	460.740	50	55	-	-
	461.306			55	60
	461.550			50	55
	461.700	-	-	50	55
	462.000	80	70	-	-
	462.209				
	462.800	30	-	-	-
	463.330	75	-	30	-
	464.416	80	-	75	-
	465.970	X25	-	-	-
	466.140	-	-	X25	-
	466.650	-	-	80	-
DUBBO TRIANGLE LOOP	461.306	-	-	X40 (112 PTS)	-
	461.381	40	-	-	-
	461.830	-	-	40	-
	463.235	-	-	X40 (114 PTS)	-
TROY JUNCTION	466.700				
	466.910	70	-	-	-
	467.150	50 (LX)	-	-	-
	467.390	-	-	70	-
	467.550	100	-	-	-
	479.940	-	-	100	-
	480.450	30	-	-	-
	480.580	-	-	30	-



DUBBO – GAP					
LOCATION	KILOMETRAGE	DOWN		UP	
		NORMAL	EXPRESS PASSENGER TRAIN	NORMAL	EXPRESS PASSENGER TRAIN
	481.400	100	-	-	-
	485.370	-	-	100	-
	485.770	75	-	-	-
	487.330	-	-	75	-
	487.490	100	-	-	-
	495.330	-	-	100	-
	495.440	75	-	-	-
	495.980	100	-	75	-
BALLIMORE	496.213				
	499.240	-	-	100	-
	499.400	75	-	-	-
	500.000	-	-	75	-
	500.100	100	-	-	-
MORONBUNG	502.901				
	503.750	-	-	100	-
	504.610	70	-	-	-
	508.680	-	-	70	-
	509.080	40	-	-	-
	509.150	-	-	40	-
	509.700	100	-	-	-
ELONG ELONG	514.351				
	515.650	30	-	100	-
	515.780	100	-	30	-
	523.670	-	-	100	-
	524.070	40	-	-	-
	524.130	-	-	40	-
	524.430	70	-	-	-
	525.687	-	-	100	-
	525.987	65	-	-	-
	528.030	-	-	65	-
	528.207	70	-	-	-
	529.530	-	-	75	-

DUBBO – GAP					
LOCATION	KILOMETRAGE	DOWN		UP	
		NORMAL	EXPRESS PASSENGER TRAIN	NORMAL	EXPRESS PASSENGER TRAIN
	529.950	90	-	-	-
	533.420	-	-	90	-
	533.580	70	-	-	-
	544.480	-	-	70	-
	544.640	100	-	-	-
	550.920	-	-	100	-
	551.020	75	-	-	-
MENDOORAN	551.863				
	552.040	30 (CLX)	-	-	-
	552.310	-	-	75	-
	553.420	100	-	-	-
	557.580	-	-	100	-
	557.740	75	-	-	-
	558.280	-	-	75	-
	558.360	100	-	-	-
	560.000	25	-	-	-
	560.350	-	-	100	-
	562.110	15	-	-	-
	562.260	-	-	50	-
MERRYGOEN	562.590 (VIA DUBBO)				
	417.798 (VIA MUDGEES)				
	418.530	75	-	-	-
	424.080	-	-	75	-
	424.500	100	-	-	-
	429.350	-	-	100	-
	429.450	75	-	-	-
	430.620	-	-	75	-
	430.700	100	-	-	-
	432.210	-	-	100	-
	432.290	75	-	-	-
	432.910	-	-	75	-
	432.990	100	-	-	-

DUBBO – GAP					
LOCATION	KILOMETRAGE	DOWN		UP	
		NORMAL	EXPRESS PASSENGER TRAIN	NORMAL	EXPRESS PASSENGER TRAIN
	434.860	-	-	100	-
	434.950	75	-	-	-
	435.530	-	-	75	-
NEILREX	435.793				
	435.715	-	-	100	-
	435.870	100	-	-	-
	436.365	40	-	-	-
	436.425	-	-	40	-
	437.075	100	-	-	-
	439.713	-	-	100	-
	440.013	85	-	-	-
	443.891	-	-	85	-
	444.191	100	-	-	-
	446.710	-	-	100	-
	446.770	80	-	-	-
	449.250	-	-	80	-
	449.610	60	-	-	-
	449.970	-	-	60	-
	450.620	100	-	-	-
	452.845	80	-	100	-
	453.495	-	-	-	-
	453.565	-	-	-	-
	454.215	-	-	-	-
	454.920	-	-	80	-
	455.020	75	-	-	-
	456.600	25			
	458.050	15			
	458.240	-	-	75	-
BINNAWAY	458.678				
	459.206	75	-	-	-
	459.241	-	-	15	-
	460.470	-	-	25	-

DUBBO – GAP					
LOCATION	KILOMETRAGE	DOWN		UP	
		NORMAL	EXPRESS PASSENGER TRAIN	NORMAL	EXPRESS PASSENGER TRAIN
	461.359	100	-	75	-
	467.675	75	-	100	-
	469.790	100	-	75	-
WEETALIBA	483.601				
	484.670	-	-	100	-
	485.320	40	-	-	-
	485.385	-	-	40	-
	486.035	100	-	-	-
	496.684	90	-	100	-
	497.569	100	-	90	-
	500.385	75	-	100	-
CONNEMARRA	503.139				
	515.392	60	-	75	-
	521.327	75	-	60	-
	524.385	90	-	75	-
	525.581	-	-	90	-
	525.881	75	-	-	-
	526.985	-	-	75	-
	527.285	90	-	-	-
	528.174	-	-	90	-
PREMER	528.259				
	528.428	70	-	-	-
	529.020	-	-	70	-
	529.670	40	-	-	-
	530.030	-	-	40	-
	530.680	100	-	-	-
	531.230	-	-	100	-
	531.880	40	-	-	-
	531.985	-	-	40	-
	532.635	100	-	-	-
TAMARANG	548.612				
SPRINGRIDGE	564.690				

DUBBO – GAP					
LOCATION	KILOMETRAGE	DOWN		UP	
		NORMAL	EXPRESS PASSENGER TRAIN	NORMAL	EXPRESS PASSENGER TRAIN
	581.102	-	-	100	-
	581.402	85	-	-	-
CAROONA	581.959				
	582.896	-	-	85	-
	583.196	100	-	-	-
	597.972	75	-	100	-
	598.844	-	-	75	-
	599.078	65	-	-	-
	599.874	-	-	65	-
GAP	600.305				

DUBBO – NARWONAH 547.550km					
LOCATION	KILOMETRAGE	DOWN		UP	
		NORMAL	PASSENGER	NORMAL	PASSENGER
ORANGE	461.700	-	-	50	55
	462.000	80	70	-	-
DUBBO	462.209	-	-	-	-
	462.690	70	-	-	-
	462.725	15	-	70	-
	463.340	-	-	15	-
	463.370	100	-	-	-
	471.200	-	-	100	-
	471.490	95	-	-	-
	471.800	-	-	95	-
	472.100	100	-	-	-
MINORE	476.695				
(MANILDRA ST CROSSING @ 496.784)	495.987	-	-	-	115
NARROMINE	497.554				
	497.800	100	-	-	-
	556.999				

DUBBO – NARWONAH 547.550km					
LOCATION	KILOMETRAGE	DOWN		UP	
		NORMAL	PASSENGER	NORMAL	PASSENGER
	556.600	-	-	55	-
	555.900	55	-		-
	555.770	-	-	90	-
	554.000	90			
	553.250	-	-	75	-
	552.510	-	-	100	-
	550.482	75	-	-	-
NARWONAH AWB	550.134				
	548.800	100	100		
	548.600			115	115
End of Section	547.550				